

DEPARTMENT OF SOCIAL WELFARE AND DEVELOPMENT  
Regional Office III  
Government Centre, Maimpis, City of San Fernando (P)

REQUEST FOR QUOTATION

RFQ No. 2023-11-001  
PR No. 2023-09-184  
Mode of Proc: NP-SVP

\*Company Name: \_\_\_\_\_  
\*Company Address: \_\_\_\_\_  
\*Contact Person: \_\_\_\_\_  
\*Contact No.: \_\_\_\_\_  
\*Email Address: \_\_\_\_\_  
\*PhilGeps Reg. No.: \_\_\_\_\_

**\*REQUIRED.** To avoid bid disqualification,  
please fill out all the items accordingly.  
Indicate "N/A" if not applicable. Thank you!

\*Title of the Project: REPAIR AND IMPROVEMENT OF EXISTING METAL FENCE OF REGIONAL REHABILITATION CENTER FOR YOUTH, BRGY. AYALA, MAGALANG, PAMPANGA  
Sir/Madam:

Please quote your government price/s including delivery charges, VAT or other applicable taxes, and other incidental expenses for the goods listed in **Annex A**. Failure to indicate information could be basis for non – compliance. Also, furnish us with **descriptive brochures, catalogues, literatures and/or samples**, if applicable.

If you are the exclusive manufacturer, distributor or agent in the Philippines for the goods listed **Annex A**, please attach in your quotation, a duly notarized certification to this effect.

Pursuant to Appendix "A" of Annex "H" of the 2016 Revised IRR of Republic Act No. 9184, interested bidders **MUST** submit the following requirements along with their bid.

**NP-Small Value Procurement**

- Philgeps Registration Number;
- Valid Mayor's Permit;

For methods of procurement requiring **Mayor's Permit** and **Philgeps Registration Number**, Updated Certificate of Philgeps Platinum Membership may be submitted in lieu of the said document

- Unnotarized Omnibus Sworn Statement (for ABCs above 50k);

If awarded, kindly submit the notarized **Omnibus Sworn Statement** within 2 days upon receipt of the **Notice of Award**.

- Latest Income/Business Tax Return (for ABCs 500k and above);
- Evidence of the offered item/s shall be submitted in the form of manufacturer's sales literature or photos with readable brand, and specifications (**i.e brochure, websites, clear pictures showing the brand, model, and description**), unconditional statements of specification and compliance issued by the manufacturer, samples, independent test data etc., as appropriate. **(This is not applicable for Catering Services)**
- For Advocacy Materials, bidders must submit EVIDENCE such as but not limited to the following, in order to support its quotation:
  - a. Clear and actual copies of sample photo(s) of items being offered with measurements and dimensions;
  - b. Clear and actual copies of sample photo(s) of similar items from previous transactions, contracts or sales;

- c. Whenever applicable, sample digital copy of design with required layout, kind of material and such other relevant specifications being offered.

Failure to attach the required documents will result in the **DISQUALIFICATION** of your bid.

Please accomplish and submit this form together with Annex A and all the required documents to DSWD FO III - BAC Secretariat either in person or electronically under the following conditions:

<b>ELECTRONIC SUBMISSION</b>	<a href="https://tinyurl.com/fo3bacsite">https://tinyurl.com/fo3bacsite</a>  in case of difficulty accessing the above link, you may access the alternate link:  <a href="https://bit.ly/fo3bacsite">https://bit.ly/fo3bacsite</a>  Select the Menu – “ <b>BID SUBMISSION</b> ”
<b>IN PERSON SUBMISSION</b>	Procurement Section, 2/f, New Building, DSWD Regional Office III, Diosdado Macapagal Government Center, Maimpis, City of San Fernando, Pampanga
<b>DEADLINE OF SUBMISSION</b>	<b>10:00 AM November 8, 2023</b>

Quotations submitted to different email address(es) as stated above shall not be considered for evaluation. Bids submitted must be in **pdf format** ONLY **clearly scanned** in a **SINGLE FILE** including supporting documents

Very truly yours,

  
**RAYMUND VINCENT A. PANLILIO**  
OIC Admin Division Chief  
Concurrent Procurement Section Chief

**Terms and Conditions:**

- Award shall be made on per: ☐ Item Basis ☒ Lot Basis
- No negative feedback/derogatory record whatsoever and/or delay of delivery of Service Provider within Three (3) months hereof.
- Quotation validity shall be: Thirty (30) Calendar Day
- Good/s/Activity shall be delivered within: Sixty (60) Calendar Days
- Place of Delivery: RRCY, BRGY. AYALA, MAGALANG, PAMPANGA
- Terms of Payment: Thirty (30) Calendar Day

Payment through LDDAP-ADA (List of Due and Demandable Accounts Payable-Advise to Debit Account).

Account Name: \_\_\_\_\_  
Account Number: \_\_\_\_\_  
Bank Name: \_\_\_\_\_  
Branch: \_\_\_\_\_

\*Note; Non-Land Bank of the Philippines accounts shall be charged a service fee.

- Liquidated Damages/Penalty: In case of failure to make full delivery within the time specified above, amount of the liquidated damages shall be at least equal to one-tenth of one percent (0.001) of the cost of the unperformed portion for every day of delay. Once the cumulative amount of liquidated damages reaches ten percent (10%) of the amount of the contract, the Procuring Entity may rescind or terminate the contract, without prejudice to other courses of action and remedies available under the circumstances.
- For goods, please indicate brand, model and country or origin.
- In case of discrepancy between unit cost and total cost, unit cost shall prevail.
- Please indicate Warranty (If applicable): \_\_\_\_\_
- Alterations: Any interlineations, erasures or overwriting shall be valid only if they are signed by the supplier or any of its duly authorized representative(s).
- NOTE: "Prospective supplier must be registered at the Philippine Government Electronic Procurement System (PhilGEPS). You may visit the PhilGEPS website at [www.philgeps.gov.ph](http://www.philgeps.gov.ph) and register for free.

  
**NOEL T. LIPATA**

RPMU

\_\_\_\_\_  
(Signature over Printed Name)  
Supplier



DEPARTMENT OF SOCIAL WELFARE AND DEVELOPMENT

NOTE: "Prospective supplier must be registered at the Philippine Government Electronic Procurement System (PhilGEPS). You may visit the PhilGEPS website at [www.philgeps.gov.ph](http://www.philgeps.gov.ph) to register."

RFQ No. 2023-11-001  
Date: \_\_\_\_\_

\*Company Name: \_\_\_\_\_  
\*Company Address: \_\_\_\_\_  
\*Contact Person: \_\_\_\_\_  
\*Contact No.: \_\_\_\_\_  
\*PhilGEPS Reg. No.: \_\_\_\_\_

ITEM NO.	QTY.	UNIT	PURCHASER'S SPECIFICATIONS	Statement of Compliance and Bidder's Specifications (Please fill out the detailed specifications in the space provided and/or write "COMPLY" if able to deliver)	UNIT COST	TOTAL COST
	1	LOT	REPAIR AND IMPROVEMENT OF EXISTING METAL FENCE OF REGIONAL REHABILITATION CENTER FOR YOUTH (RRCY)			
			Other Requirements to be Submitted:			
			> List of Key Personnel (Please attached their ID's)			
			> List of minimum major equipment/tools requirement			
			> Attach/Submit your accomplished Program of Works, Bill of Quantities and please check Terms of Reference for Project Details			
			* NOTHING FOLLOWS *			
			Approved Budget for the Contract: PhP 147,295.75			

Please do not leave any blank items.

TOTAL OFFERED QUOTATION / BID

In WORDS:	In FIGURES:
_____	PHP _____
_____	

PURPOSE: REPAIR AND IMPROVEMENT OF EXISTING METAL FENCE OF REGIONAL REHABILITATION CENTER FOR YOUTH, BRGY. AYALA, MAGALANG, PAMPANGA.

PR No. 2023-09-184

IMPORTANT: The winning bidder **MUST SIGN** the original copy of Purchase Order (P.O) at DSWD-Regional Office III, Procurement Section within 48 hours from its issuance.

**FAILURE** to show up and sign the original P.O means that the bidder is not interested and will be a ground for suspension or blacklisting in DSWD's future biddings.

Please carefully re-check your bid (i.e. price, technical specifications and delivery date.) DSWD Field Office III implements a "NO MODIFICATION and NO DELIVERY EXTENSION POLICY"

  
**RAYMUND VINCENT A. PANLILIO**  
OIC - Admin Division Chief  
Concurrent Procurement Section Chief

\_\_\_\_\_  
Supplier

DRN: III-FO-PSD-CBSS-RRCY-SS-PROP-23-08-49722-S

## TERMS OF REFERENCE

### REGIONAL REHABILITATION CENTER FOR YOUTH'S REPAIR AND IMPROVEMENT OF EXISTING METAL FENCE

#### A. Background/Rationale

The Department of Social Welfare and Development-Regional Rehabilitation Center for Youth is mandated by law to provide rehabilitation program to Children in Conflict with the Law (CICL) whose sentence have been suspended- 30% out of the total population. Majority or 70% of the residents' status of case are on trial. Based on statistics report CY 2022, a total of 218 CICL had been served last year – 2022 and currently RRCY has serves 143 CICLs, and with a total target serve of 243.

One of priorities of the DSWD is to make all residential facilities including RRCY become center of excellence to ensure provision of services with high quality to its clients. Facility Management is one (1) of the five (5) work areas that has to comply with the RRCY that would contribute to level III accreditation.

The existing Metal Fence that can control the residents from leaving the center without permission and protect them from falling or slipping into stiffer/hilly side of the center, It is located at the side part of the gymnasium and the back part of the rest house which is already dilapidated and not stable hence immediate repair and improvement is imperative.

#### B. Objectives

1. To repair and improve the existing metal fence of RRCY
2. To ensure the safety and protection of all residents, staff and visitors from falling/slipping into the hilly side of the center; and
3. To control residents from leaving the center without permission.

### **C. Scope of Works**

The Protective Services Division – Center Based Services Section is responsible for ensuring the compliance of 7s Good Housekeeping in order to achieve the organization's vision and goal. Thus, in order to ensure the section's contribution in the achievement of the said vision, the proposal Repair and Improvement of Guard House at Regional Rehabilitation Center for Youth is being made. The following Scope of Works is as follows:

#### **1. Repair and Improvement of Existing Metal Fence at Regional Rehabilitation Center for Youth with the following Inclusions**

- Demolition
- Structural Excavation(Common Soil)
- Embankment from Structure Excavation
- Gravel Fill
- Structural Concrete for Footing Tie Beam, Column, Suspended Slab, Girded/Beam (Class A, 28 Days)
- Fabrication/erection and setting up of Reinforcing bars for Stair footings, suspended slab and Septic
- Form, False works, braces, ribs and Setting for Suspended slab
- 4" Sch.40 G.I. Pipe
- 1 1/2 " Sch. 40 G.I. Pipe
- 20 mm x 3 mm thk Flat Bar
- Steel Matting 2" x 2" x 2 mm GI
- Base Plate (150 mm x 150 mm x 8 mm thk)
- Anchor Bolts (12 mm dia.) w/ Nuts and Washers

### **D. Schedule of Works**

The project duration is SIXTY (60) Calendar days and will commence a day after the pre-construction meeting or as per agreed upon if necessary permits are required. Particulars project duration are as follows;

<b>Particulars</b>	<b>Project Duration</b>
REPAIR AND IMPROVEMENT OF EXISTING METAL FENCE	60 Calendar Days

**E. Qualification, Duties and Responsibilities of the Service Provider**

See Contractor's Terms of References

**Prepared by:**

  
**ENGR. ROMMEL G. VELASCO**  
Engineer II / RPMT

**Checked and reviewed by:**

  
**ENGR. PAUL ANDREW B. DARACAN**  
PDO II General Services Division / TWG –  
Infrastructure & Building Maintenance

**Recommending approval as to purpose:**

  
**PRISCILA Q. TIOPENGCO**  
Protective Services Division Chief

**Certified as to funding compliance with the budget Parameters and inclusion in the WFP:**

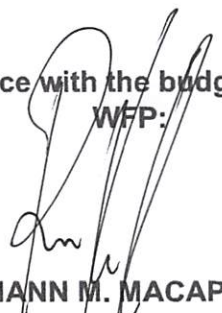
  
**RENANN M. MACAPINLAC**  
Budget Section Chief

**Approved/Disapproved:**

  
**JONATHAN V. DIRAIN**  
Regional Director



DRN III-FO-PSD-CBSS-RCY-SS-PROP-23-08-49772-S

CONTRACTOR'S TERMS OF REFERENCE									
Name of Project:  <b>REPAIR AND IMPROVEMENT OF EXISTING METAL FENCE</b>		Location:  <b>REGIONAL REHABILITATIONC CENTER FOR YOUTH, BGRY. AYALA, MAGALANG, PAMPANGA</b>							
Total Project Cost:	<b>PHP 147,295.75</b>	Project Duration:	<b>60 CALENDAR DAYS</b>						
Source of Fund:	<b>TRUST FUND</b>	Mode of Procurement:	<b>NEGOTIATED PROCUREMENT/SVP</b>						
Date of POW:	<b>SEPTEMBER 14, 2023</b>	Source of Manpower:	<b>OUTSOURCE</b>						
<b>GENERAL CONDITION AND REQUIREMENTS</b>									
<p><b>A.) Contractor's Qualification(s)</b></p> <p>1.) Service Provider/ Contractor shall have a Single Largest Contract with similar project contract and scope such as construction, improvement/ rehabilitation/ repair of building interior/ exterior works completed within the Three(3) years from the deadline of bid submission, whose the value of contract amount must at least fifty percent (50%) of the ABC with supported by the Contractors Performance Evaluation System rating or a certificate of satisfactory rating or certificate of satisfactory completion of the project issued by the owner of the previous completed project.</p> <p>2.) Service Provider/ Contractor required license Category for the Philippines Contractor's Accreditation Board Circular No. 001, series of 2009</p> <table border="1"> <thead> <tr> <th>Size Range</th> <th>License Category</th> <th>Classification</th> </tr> </thead> <tbody> <tr> <td>At least Small B</td> <td>C &amp; D</td> <td>General Engineering/ General Building</td> </tr> </tbody> </table>				Size Range	License Category	Classification	At least Small B	C & D	General Engineering/ General Building
Size Range	License Category	Classification							
At least Small B	C & D	General Engineering/ General Building							
<p><b>B.) Contractor's Working Hours</b></p> <p>1.) All normal works for regular days of this contract shall be performed during office hours (8:00 am to 5:00 pm), including Weekends, Holiday and Special Holiday with proper coordination/approval to RPMT Implementing Team.</p>									

- 2.) The Contractor/Service Provider shall be required to furnish safe, proper and sufficient lighting arrangement during overnight works.
- 3.) Weekends/holidays shall deploy a maximum number of manpower based on the submitted *Contractors Schedule*, just to catch-up the possible delays due to possible stoppage instructed by RPMT Implementing Team.

**C.) Contractor's Responsibilities and Conditions**

- 1.) Contractor/Service Provider shall request a Pre-Construction Meeting with RPMT Engineer and Center head before the start of work.
- 2.) Contractor shall control the generation of dust and flying particles from the operation and shall provide a temporary closure to prevent creation of nuisance to the adjacent offices/rooms;
- 3.) Contractor/ Service Provider shall submit own construction schedule, manpower deployment schedule, equipment's/ tools schedule, list of manpower to be deployed and Project Site organizational structure within five (5) days upon received of Notice of Award;
- 4.) Contractor/Service provider shall assign project engineer/project architect from the start until completion stage;
- 5.) Contractor/Service provider shall coordinate to the RPMT Implementing Team all the execution works;
- 6.) Contractor/Service provider shall provide warning signages, project signboard, contractors project log book;
- 7.) Contractor/Service provider's workers shall sign on the logbook before entering the premises as reference of the DSWD-Regional Center security guards.
- 8.) Contractor/Service provider shall provide/submit Statement of Works Accomplishment, Progress Photos and Narrative report as requirement of the billing request;
- 9.) Contractor/Service provider shall submit weekly progress reports with attached progress photos to RPMT Implementing team;
- 10.) Contractor/Service provider shall provide delivery receipt or list of all materials brought inside the compound including the list of equipment and tools;
- 11.) Contractor/Service provider shall provide complete uniform with ID and basic PPE for all the construction worker and personnel; and
- 12.) The Contractor/Service Provider shall ensure the sufficient number of manpower to complete the project within the agreed timeline/duration. The key personnel requirements shall be as follows;

Key Personnel	Requirements	Experience
One (1) Project Engineer/Architect	One (1) Licensed Civil Engineer or One (1) Licensed Architect	Minimum of Three (3) years of Relevant Experience
One (1) General Foreman	Dedicated Foreman per Project	Minimum of Five (5) years of Finishing works in Construction Industry

- 13.) For each project they bid on, the successful contractor/service provider is responsible for obtaining all necessary licenses and permits.



- 14.) The Contractor/Service Provider shall strictly comply/observe the Construction Safety Guidelines for the Implementation of All Infrastructure Projects during the Covid-19 Public Health Crisis as per DPWH Department Order No. 35 Series of 2020. (see Annex D)
- 15.) Except for the service truck, which may be used in a different center, the contractor's specified equipment may not be used again if they have won another project with a different center and may only be utilized if they have won at least two projects within the same center. In the event that the equipment is rented, the contractor or service provider shall submit a copy of the lease agreement.
- 17.) The backhoe ratio will rely on the evaluation of our designated RPMT engineers, but if they do not make an assessment, the required ratio is 1:1. The specified equipment of the contractor may only be used if they have won at least two projects with the same center, and may not be used again if they have won another project with a different center. The contractor or service provider must produce a copy of the lease agreement if the equipment is rented.

#### **D.) Recommended Terms of Payment**

- 1.) The Payment for this project shall be made upon completion of the following activity/scope of works:

<b>Payment Tranches</b>	<b>Outputs/ Deliverables</b>
One (1) Time Payment 100 % payment of the total Contract cost less 10% Retention.	Must be Hundred Percent (100%) physical completed Upon with submission of Billing Statement, Contractor's accomplishment reports, Statement of Work Accomplished, Progress Photos, Narrative report, Contractor's certificate of completion, contractors warranty security, contractors request for acceptance and turn-over certificate; and Notarized certificate of warranty.
Final payment: 10 % payment of the total contract price (10% Retention Money)	Must be one (1) month and without damage/defect of installed items and Upon Submission of Contractors warranty security issued by the private insurance company, Notarized Certificate of Warranty.

#### **E.) Contractor's Minimum Major Equipment and Tools Requirements**

- 1.) List of Minimum major equipment/ tools requirement are the following

- 1.) List of Minimum major equipment/ tools requirement are the following

		1 unit one-bagger concrete mixer		1-unit Service Truck (at least ELF)		

**F.) Other General Requirements**

- 1 All dimensions/level etc. indicated in the drawing plans are to be verified on the site;
- 2 All materials are subjected for the approval by the End- user/RPMT Project Engineer;
- 3 Any discrepancies, either between written dimensions and site dimensions shall be brought to the RPMT office before executing the works;
- 4 All equipment, tools, scaffolding and other personnel needed shall be provided by the service provider/contractor;
- 5 Removal, dismantling and demolition work shall be coordinated and requested to the RPMT Implementing Team;
- 6 All waste materials shall be turned over to the RPMT Implementing Team with proper documentation;
- 7 No additional/extra cost to be claimed/charged by the Contractor for the Construction Works alone other than those expressly approved by the Procuring Entity
- 8 All works shall comply with the National Building Code of the Philippines, Fire Code of the Philippines, Philippine Electrical Code and Department rules and Regulations and other relevant laws, rules and regulations.

**4.2 To ensure the timely implementation of infrastructure projects and effective management of the performance of contractors, the following calibrated actions in response to delays in the implementation of infrastructure projects are hereby adopted:**

**4.2.1 Negative slippage of five percent (5%)** - The contractor shall be given a warning and be required to:

4.2.1.1 Submit a detailed "catch-up" program every two weeks in order to eliminate the slippage and to restore the project to its original schedule;

4.2.1.2 Accelerate work and identify specific physical targets to be accomplished over a definite period of time; and

4.2.1.3 Provide additional input resources such as the following; money, manpower, materials, equipment, and management, which shall be mobilized for this action.

**4.2.2 Negative slippage of ten percent (10%)** -

The contractor shall be issued a final warning and be required to come-up with revised detailed "catch-up" program with weekly physical targets together with the required additional input resources.

The implementing unit shall intensify on-site supervision and evaluation of the project performance to at least once a week and prepare contingency plans for a possible termination of the contract or take-over of the work by administration or contract.

**4.2.3 Negative slippage of fifteen percent (15%)** -

The contractor shall be issued a final warning and be required to come-up with a revised detailed "catch-up" program with weekly physical targets together with the required additional input resources.

The implementing unit shall intensify on-site supervision and evaluation of the project performance to at least once a week and prepare contingency plans for a possible termination of the contract or take-over of the work by administration or contract.

Prepared by:

  
**ROMMEL G. VELASCO**  
PDO II/ SITE ENGINEER / RPMT

Checked and Reviewed by:

  
**PAUL ANDREW B. DARACAN**  
PDO II/EE - Gen. Services Section/  
TWG Infrastructure & Building  
Maintenance

Submitted by:

  
**ROBERT V. GATMAITAN**  
Center Head

Certified as to Funding Compliance with  
Budget Parameters and Inclusion in the  
WFP:

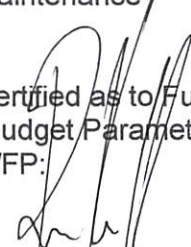
  
**RENANN M. MACAPINLAC**  
Budget Officer

Recommending approval:

  
**MARIBEL M. BLANCO**  
ARD for Administration

Approved / Disapproved:

  
**JONATHAN V. DIRAIN**  
Regional Director



DRN: III-FO-PSD-CBSS-RCY-SS-PROP-23-08-49772-S

SCHEDULE OF WORKS					
Date: September 14, 2023			Project/TA Control #:		
Name of Project: REPAIR AND IMPROVEMENT OF EXISTING METAL FENCE			Location: Regional Rehabilitation Center for Youth, Brgy. Ayala, Magalang, Pampanga		
ACTIVITY / SCOPE OF WORKS	START DATE	FINISH DATE	DURATION (DAYS)	REMARKS	
Clearing and Grubbing	DAY 1	DAY 5	5		
Structure Excavation, Common Soil	DAY 8	DAY 20	13		
Embankment, from Structure Excavation	DAY 30	DAY 40	11		
Gravel Fill	DAY 30	DAY 40	11		
Structural Concrete	DAY 35	DAY 45	11		
Footing Tie Beams, Beam, Girder, Columns, Suspended Slab)					
Reinforcing Steel (Deformed), Grade 40	DAY 35	DAY 50	6		
Formworks and Falseworks	DAY 40	DAY 45	6		
4" Sch.40 G.I. Pipe	DAY 40	DAY 50	11		
1 1/2 " Sch. 40 G.I. Pipe	DAY 40	DAY 60	11		
20 mm x 3 mm thk Flat Bar	DAY 40	DAY 60	11		
Steel Matting 2" x 2" x 2 mm GI	DAY 40	DAY 60	11		
Base Plate (150 mm x 150 mm x 8 mm thk)	DAY 40	DAY 60	11		
Anchor Bolts (12 mm dia.) w/ Nuts and Washers	DAY 40	DAY 60	11		

SUMMARY		
1. This approved Schedule of Works shall be properly executed.	Target Date of Start	One (1) Day after Pre-Construction Meeting
2. Any changes/revision shall be subjected for re-approval of New Schedule of Works.	Target Completion Date	60 Days from Start
3. The Project Duration would start directly after the pre construction meeting.	Project Duration	60 Calendar Days

Prepared by:

  
**ROMMEL G. VELASCO**  
 PDO II/ SITE ENGINEER / RPMT

Checked and Reviewed by:

  
**PAUL ANDREW B. DARACAN**  
 PDO II/EE - GEN. SERVICES SECTION /  
 TWG Infrastructure & Building Maintenance

Submitted by:

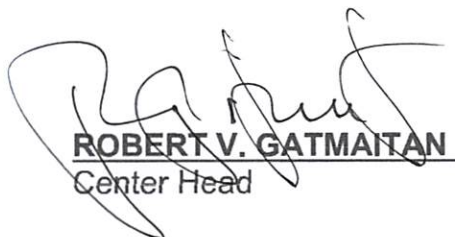
  
**ROBERT V. GATMAITAN**  
 Center Head

Certified as to Funding Compliance with  
 Budget Parameters and Inclusion in the  
 WFP.

  
**RENANN M. MACAPINLAC**  
 Budget Officer

Recommending approval:

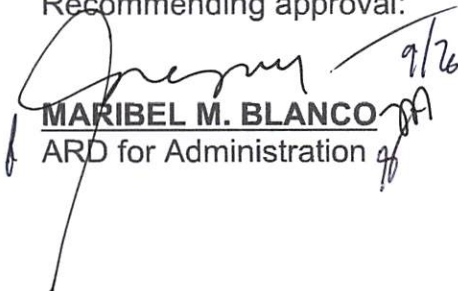
  
**MARIBEL M. BLANCO**  
 ARD for Administration 9/26

Approved / Disapproved:

  
**JONATHAN V. DIRAIN**  
 Regional Director



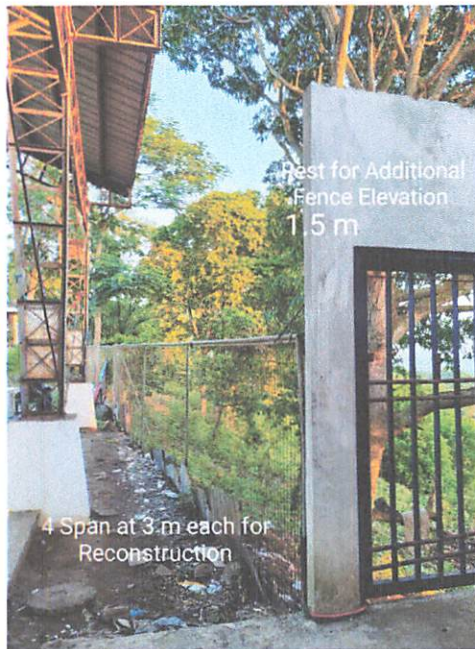

EXISTING  
SCALE NTS

CONCEPTUAL DESIGN  
SCALE NTS

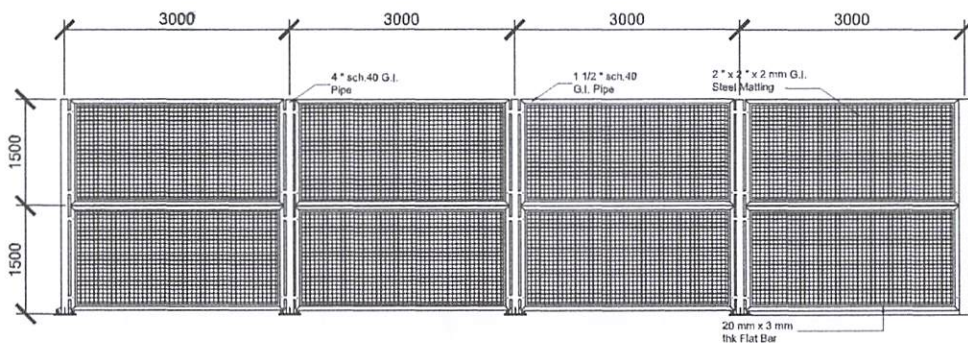

FENCE ELEVATION  
SCALE 1:100 M.

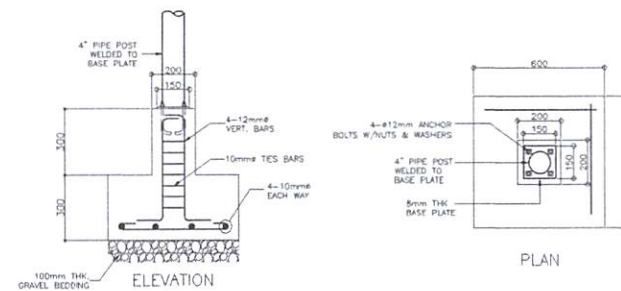

PEDESTAL DETAIL  
SCALE 1:10 M.

**PROJECT NAME :**  
REPAIR AND IMPROVEMENT OF  
EXISTING METAL FENCE

**LOCATION :**  
REGIONAL REHABILITATION CENTER FOR YOUTH  
Brgy. Ayala, Magalang, Pampanga

**SHEET CONTENT :**  
AS SHOWN

**APPROVED BY**

**JONATHAN V. DIRAIN**

Regional Director, DSWD FO III

**RECOMMENDING APPROVAL**

**MARIBEL M. BLANCO**

Assistant Regional Director for Administration

Certified as to Funding Compliance with Budget  
Parameters and Inclusion in the WFP:

**RENANN M. MACAPINLAC**

Regional Director III

**CHECKED AND REVIEWED BY**

**ENGR. PAUL ANDREW B. DARACAN**

PDO II - EE, General Services Section

**PREPARED/SUBMITTED BY**

**DOMMEL G. VELASCO/ROBERT V. GATMATAN**

Engineer II/Centerhead

**DRAWING STATUS**

DATE	DESCRIPTION/ REMARKS	BY

PLAN CATEG.	SHEET NUMBER	PAPER SIZE
<b>A,S</b>	<b>1/1</b>	<b>A4</b>



**DETAILED UNIT PRICE ANALYSIS (DUPA)**

Project : **REPAIR AND IMPROVEMENT OF EXISTING METAL FENCE**

Location : REGIONAL REHABILITATION CENTER FOR YOUTH, AYALA, MAGALANG, PAMPANGA

Item No./Description : 1047(3)a Anchor Bolts

Unit of Measurement : pc

Output per hour : 1.000 pc

	Designation	No. of Person	No. of Hours	Hourly Rate	Amount
A.	Labor				
	a. Construction Foreman	1	0.10		0.00
	b. Skilled Labor	1	0.10		0.00
	c. Unskilled Labor	1	0.10		0.00
	Sub-Total for A				0.00
	Name and Capacity	No. of Units	No. of Hours	Hourly Rate	Amount
B.	Equipment				
	Minor Tools (10% of labor Cost)				0.00
	Sub-Total for B				0.00
C.	Total (A + B)				0.00
D.	Output per hour = 1.000 pc				
E.	Direct Unit Cost (C ÷ D)				0.00
	Name and Specification	Unit	Quantity	Unit Cost	Amount
F.	Materials				
	a. Anchor Bolt	pc	1.00		0.00
	Sub-Total for F				0.00
G.	Direct Unit Cost ( E + F )				0.00
H.	Overhead, Contingencies and Miscellaneous (OCM)			0.15 of G	0.00
I.	Contractor's Profit (CP)			0.10 of G	0.00
J.	Value Added Tax (VAT)			0.05 of (G + H + I)	0.00
K.	Total Unit Cost			(G + H + I + J)	<b>0.00</b>

Prepared by:

Submitted by:

**ROMMEL G. VELASCO**  
Engineer II

**ROBERT V. GATMAITAN**  
Center Head

**DETAILED UNIT PRICE ANALYSIS (DUPA)**

Project : **REPAIR AND IMPROVEMENT OF EXISTING METAL FENCE**

Location : REGIONAL REHABILITATION CENTER FOR YOUTH, AYALA, MAGALANG, PAMPANGA

Item No./Description : 150 mm x 150 mm x 8 mm Base Plate

Unit of Measurement : ls

Output per hour : 1.00

	Designation	No. of Person	No. of Hours	Hourly Rate	Amount
A.	Labor				
	a. Construction Foreman	1	4.00		0.00
	b. Skilled Labor	1	4.00		0.00
	c. Unskilled Labor	1	4.00		0.00
	Sub-Total for A				0.00
	Name and Capacity	No. of Units	No. of Hours	Hourly Rate	Amount
B.	Equipment				
	a.Minor Tools(10% of Labor Cost)				0.00
	Sub-Total for B				0.00
C.	Total (A + B)				0.00
D.	Output per hour = 1.00				
E.	Direct Unit Cost (C ÷ D)				0.00
	Name and Specification	Unit	Quantity	Unit Cost	Amount
F.	Materials				
	a. 150 mm x 150 mm x 8 mm Base Plate	pcs	4.00		0.00
	b. Consumables (3% of Materials Cost)				0.00
	Sub-Total for F				0.00
G.	Direct Unit Cost ( E + F )				0.00
H.	Overhead, Contingencies and Miscellaneous (OCM)			0.15 of G	0.00
I.	Contractor's Profit (CP)			0.10 of G	0.00
J.	Value Added Tax (VAT)			0.05 of (G + H + I)	0.00
K	Total Unit Cost			(G + H + I + J)	<b>0.00</b>

Prepared by:

Submitted by:

**ROMMEL G. VELASCO**  
Engineer II

**ROBERT V. GATMAITAN**  
Center Head

### DETAILED UNIT PRICE ANALYSIS (DUPA)

Project : **REPAIR AND IMPROVEMENT OF EXISTING METAL FENCE**

Location : REGIONAL REHABILITATION CENTER FOR YOUTH, AYALA, MAGALANG, PAMPANGA

Item No./Description : 2 " x 2 " x 2 mm G.I. Steel Matting

Unit of Measurement : ls

Output per hour : 1.00

	Designation	No. of Person	No. of Hours	Hourly Rate	Amount
A.	Labor				
	a. Construction Foreman	1	31.00		0.00
	b. Skilled Labor	1	31.00		0.00
	c. Unskilled Labor	1	31.00		0.00
	Sub-Total for A				0.00
	Name and Capacity	No. of Units	No. of Hours	Hourly Rate	Amount
B.	Equipment				
	a.Minor Tools(10% of Labor Cost)				0.00
	Sub-Total for B				0.00
C.	Total (A + B)				0.00
D.	Output per hour = 1.00				
E.	Direct Unit Cost (C ÷ D)				0.00
	Name and Specification	Unit	Quantity	Unit Cost	Amount
F.	Materials				
	a. 2 " x 2 " x 2 mm G.I. Steel Matting	sq.m	36.00		0.00
	b. Consumables (3% of Materials Cost)				0.00
	Sub-Total for F				0.00
G.	Direct Unit Cost ( E + F )				0.00
H.	Overhead, Contingencies and Miscellaneous (OCM)			0.15 of G	0.00
I.	Contractor's Profit (CP)			0.10 of G	0.00
J.	Value Added Tax (VAT)			0.05 of (G + H + I)	0.00
K	Total Unit Cost			(G + H + I + J)	<b>0.00</b>

Prepared by:

Submitted by:

**ROMMEL G. VELASCO**  
Engineer II

**ROBERT V. GATMAITAN**  
Center Head



### DETAILED UNIT PRICE ANALYSIS (DUPA)

Project : **REPAIR AND IMPROVEMENT OF EXISTING METAL FENCE**

Location : REGIONAL REHABILITATION CENTER FOR YOUTH, AYALA, MAGALANG, PAMPANGA

Item No./Description : 20 mm x 3 mm thk Flat Bar

Unit of Measurement : ls

Output per hour : 1.00

	Designation	No. of Person	No. of Hours	Hourly Rate	Amount
A.	Labor				
	a. Construction Foreman	1	30.00		0.00
	b. Skilled Labor	1	30.00		0.00
	c. Unskilled Labor	1	30.00		0.00
	Sub-Total for A				0.00
	Name and Capacity	No. of Units	No. of Hours	Hourly Rate	Amount
B.	Equipment				
	a.Minor Tools(10% of Labor Cost)				0.00
	Sub-Total for B				0.00
C.	Total (A + B)				0.00
D.	Output per hour = 1.00				
E.	Direct Unit Cost (C ÷ D)				0.00
	Name and Specification	Unit	Quantity	Unit Cost	Amount
F.	Materials				
	a. 20 mm x 3 mm thk Flat Bar	pcs	12.00		0.00
	b. Consumables (3% of Materials Cost)				0.00
	Sub-Total for F				0.00
G.	Direct Unit Cost ( E + F )				0.00
H.	Overhead, Contingencies and Miscellaneous (OCM)			0.15 of G	0.00
I.	Contractor's Profit (CP)			0.10 of G	0.00
J.	Value Added Tax (VAT)			0.05 of (G + H + I)	0.00
K.	Total Unit Cost			(G + H + I + J)	<b>0.00</b>

Prepared by:

Submitted by:

**ROMMEL G. VELASCO**  
Engineer II

**ROBERT V. GATMAITAN**  
Center Head

**DETAILED UNIT PRICE ANALYSIS (DUPA)**

Project : **REPAIR AND IMPROVEMENT OF EXISTING METAL FENCE**

Location : REGIONAL REHABILITATION CENTER FOR YOUTH, AYALA, MAGALANG, PAMPANGA

Item No./Description : 1 1/2 " sch. 40 G.I. Pipe

Unit of Measurement : ls

Output per hour : 1.00

	Designation	No. of Person	No. of Hours	Hourly Rate	Amount
A.	Labor				
	a. Construction Foreman	1	31.00		0.00
	b. Skilled Labor	1	31.00		0.00
	c. Unskilled Labor	1	31.00		0.00
	Sub-Total for A				0.00
	Name and Capacity	No. of Units	No. of Hours	Hourly Rate	Amount
B.	Equipment				
	a.Minor Tools(10% of Labor Cost)				0.00
	Sub-Total for B				0.00
C.	Total (A + B)				0.00
D.	Output per hour = 1.00				
E.	Direct Unit Cost (C ÷ D)				0.00
	Name and Specification	Unit	Quantity	Unit Cost	Amount
F.	Materials				
	a. 1 1/2 " sch. 40 G.I. Pipe	pcs	12.00		0.00
	b. Consumables (3% of Materials Cost)				0.00
	Sub-Total for F				0.00
G.	Direct Unit Cost ( E + F )				0.00
H.	Overhead, Contingencies and Miscellaneous (OCM)			0.15 of G	0.00
I.	Contractor's Profit (CP)			0.10 of G	0.00
J.	Value Added Tax (VAT)			0.05 of (G + H + I)	0.00
K	Total Unit Cost			(G + H + I + J)	<b>0.00</b>

Prepared by:

Submitted by:

**ROMMEL G. VELASCO**  
Engineer II

**ROBERT V. GATMAITAN**  
Center Head

### DETAILED UNIT PRICE ANALYSIS (DUPA)

Project : **REPAIR AND IMPROVEMENT OF EXISTING METAL FENCE**  
 Location : REGIONAL REHABILITATION CENTER FOR YOUTH, AYALA, MAGALANG, PAMPANGA  
 Item No./Description : 4 " sch. 40 G.I. Pipe  
 Unit of Measurement : ls  
 Output per hour : 1.00

	Designation	No. of Person	No. of Hours	Hourly Rate	Amount
A.	Labor				
	a. Construction Foreman	1	14.00		0.00
	b. Skilled Labor	1	14.00		0.00
	c. Unskilled Labor	1	14.00		0.00
	Sub-Total for A				0.00
	Name and Capacity	No. of Units	No. of Hours	Hourly Rate	Amount
B.	Equipment				
	a.Minor Tools(10% of Labor Cost)				0.00
	Sub-Total for B				0.00
C.	Total (A + B)				0.00
D.	Output per hour = 1.00				
E.	Direct Unit Cost (C ÷ D)				0.00
	Name and Specification	Unit	Quantity	Unit Cost	Amount
F.	Materials				
	a. 4 " sch.40 G.I. Pipe	pcs	2.00		0.00
	b. Consumables (3% of Materials Cost)				0.00
	Sub-Total for F				0.00
G.	Direct Unit Cost ( E + F )				0.00
H.	Overhead, Contingencies and Miscellaneous (OCM)			0.15 of G	0.00
I.	Contractor's Profit (CP)			0.10 of G	0.00
J.	Value Added Tax (VAT)			0.05 of (G + H + I)	0.00
K	Total Unit Cost			(G + H + I + J)	<b>0.00</b>

Prepared by:

Submitted by:

**ROMMEL G. VELASCO**  
 Engineer II

**ROBERT V. GATMAITAN**  
 Center Head

### DETAILED UNIT PRICE ANALYSIS (DUPA)

Project : **REPAIR AND IMPROVEMENT OF EXISTING METAL FENCE**  
 Location : REGIONAL REHABILITATION CENTER FOR YOUTH, AYALA, MAGALANG, PAMPANGA  
 Item No./Description : 903(2) Formworks and Falseworks  
 Unit of Measurement : sq.m.  
 Output per hour : 3.24

	Designation	No. of Person	No. of Hours	Hourly Rate	Amount
A.	Labor				
	Installation				
	a. Construction Foreman	1	1		-
	b. Skilled Labor	2	1		-
	c. Unskilled Labor	4	1		-
	Stripping				
	a. Construction Foreman	1	0.41		-
	b. Unskilled Labor	6	0.41		-
	Sub-Total for A				-
	Name and Capacity	No. of Units	No. of Hours	Hourly Rate	Amount
B.	Equipment				
	a. Minor Tools(10% of Labor Cost)				-
	Sub-Total for B				-
C.	Total (A + B)				-
D.	Output per hour = 3.24 sq.m				
E.	Direct Unit Cost (C ÷ D)				-
	Name and Specification	Unit	Quantity	Unit Cost	Amount
F.	Materials				
	a. Phenolic Board - 3 uses	pc	0.347		-
	b. Good Lumber - 3 uses	bd.ft.	7.190		-
	c. Assorted Common Wired Nails	kg	0.21		-
	c. Consumables (5% of Materials Cost)				-
	Sub-Total for F				-
G.	Direct Unit Cost ( E + F )				-
H.	Overhead, Contingencies and Miscellaneous (OCM)			0.15 of G	-
I.	Contractor's Profit (CP)			0.10 of G	-
J.	Value Added Tax (VAT)			0.05 of (G + H + I)	-
K.	Total Unit Cost			(G + H + I + J)	-

Prepared by:

Submitted by:

**ROMMEL G. VELASCO**  
 Engineer II

**ROBERT V. GATMAITAN**  
 Center Head



### DETAILED UNIT PRICE ANALYSIS (DUPA)

Project : **REPAIR AND IMPROVEMENT OF EXISTING METAL FENCE**  
 Location : REGIONAL REHABILITATION CENTER FOR YOUTH, AYALA, MAGALANG, PAMPANGA  
 Item No./Description : 902(1) Reinforcing Steel of Reinforced Concrete Structures for One-Storey, Grade 40/Grade 60  
 Unit of Measurement : kg  
 Output per hour : 143.438

	Designation	No. of Person	No. of Hours	Hourly Rate	Amount
A.	Labor				
	a. Construction Foreman	1	1		-
	b. Skilled Labor	3	1		-
	c. Unskilled Labor	12	1		-
	Sub-Total for A				-
	Name and Capacity	No. of Units	No. of Hours	Hourly Rate	Amount
B.	Equipment				
	a. Bar Cutter	1	0.5		-
	b. Bar Bender	1	0.5		-
	Minor Tools (10% of Labor Cost)				-
	Sub-Total for B				-
C.	Total (A + B)				-
D.	Output per hour = 143.438 kgs				
E.	Direct Unit Cost (C ÷ D)				-
	Name and Specification	Unit	Quantity	Unit Cost	Amount
F.	Materials				
	a. Deformed Reinforcing Steel	kg	1		-
	b. #16 Galvanized Iron Wire	kg	0.015		-
	c. Consumables (5% of Materials Cost)				-
	Sub-Total for F				-
G.	Direct Unit Cost ( E + F )				-
H.	Overhead, Contingencies and Miscellaneous (OCM)			0.15 of G	-
I.	Contractor's Profit (CP)			0.10 of G	-
J.	Value Added Tax (VAT)			0.05 of (G + H + I)	-
K.	Total Unit Cost			(G + H + I + J)	-

Prepared by:

Submitted by:

**ROMMEL G. VELASCO**  
 Engineer II

**ROBERT V. GATMAITAN**  
 Center Head

### DETAILED UNIT PRICE ANALYSIS (DUPA)

Project : **REPAIR AND IMPROVEMENT OF EXISTING METAL FENCE**

Location : REGIONAL REHABILITATION CENTER FOR YOUTH, AYALA, MAGALANG, PAMPANGA

Item No./Description : 900(1) Structural Concrete for Footing Tie Beam, Column, Suspended Slab, Girder/Beam (Class A, 28 days)

Unit of Measurement : cu.m.

Output per hour : 3.32

	Designation	No. of Person	No. of Hours	Hourly Rate	Amount
A.	Labor				
	a. Construction Foreman	1	1		-
	b. Skilled Labor	2	1		-
	c. Unskilled Labor	6	1		-
	Sub-Total for A				-
	Name and Capacity	No. of Units	No. of Hours	Hourly Rate	Amount
B.	Equipment				
	a. Concrete Vibrator	2	1		-
	b. Pumpcrete	1	0.27		-
	Minor Tools (10% of Labor Cost)				-
	Sub-Total for B				-
C.	Total (A + B)				-
D.	Output per hour = 3.32 cu.m.				
E.	Direct Unit Cost (C ÷ D)				-
	Name and Specification	Unit	Quantity	Unit Cost	Amount
F.	Materials				
	a. Ready Mix Concrete 3000PSI, 28 days	cu.m.	1.05		-
	Sub-Total for F				-
G.	Direct Unit Cost ( E + F )				-
H.	Overhead, Contingencies and Miscellaneous (OCM)			0.15 of G	-
I.	Contractor's Profit (CP)			0.10 of G	-
J.	Value Added Tax (VAT)			0.05 of (G + H + I)	-
K.	Total Unit Cost			(G + H + I + J)	-

Prepared by:

Submitted by:

**ROMMEL G. VELASCO**  
Engineer II

**ROBERT V. GATMAITAN**  
Center Head

### DETAILED UNIT PRICE ANALYSIS (DUPA)

Project : **REPAIR AND IMPROVEMENT OF EXISTING METAL FENCE**  
 Location : REGIONAL REHABILITATION CENTER FOR YOUTH, AYALA, MAGALANG, PAMPANGA  
 Item No./Description : 804(4) Gravel Fill  
 Unit of Measurement : cu.m.  
 Output per hour : 1.200

	Designation	No. of Person	No. of Hours	Hourly Rate	Amount
A.	Labor				
	a. Construction Foreman	1	1		-
	b. Unskilled Labor	3	1		-
	Sub-Total for A				-
	Name and Capacity	No. of Units	No. of Hours	Hourly Rate	Amount
B.	Equipment				
	a. Plate Compactor (5 hp)	1	0.5		-
	Minor Tools (10% of Labor Cost)				-
	Sub-Total for B				-
C.	Total (A + B)				-
D.	Output per hour = 1.2 cu.m.				
E.	Direct Unit Cost (C ÷ D)				-
	Name and Specification	Unit	Quantity	Unit Cost	Amount
F.	Materials				
	a. Gravel Bedding (G1) (w/ 5% Shrinkage Factor)	cu.m.	1.05		-
	Sub-Total for F				-
G.	Direct Unit Cost ( E + F )				-
H.	Overhead, Contingencies and Miscellaneous (OCM)			0.15 of G	-
I.	Contractor's Profit (CP)			0.10 of G	-
J.	Value Added Tax (VAT)			0.05 of (G + H + I)	-
K.	Total Unit Cost			(G + H + I + J)	-

Prepared by:

Submitted by:

**ROMMEL G. VELASCO**  
 Engineer II

**ROBERT V. GATMAITAN**  
 Center Head

### DETAILED UNIT PRICE ANALYSIS (DUPA)

Project : **REPAIR AND IMPROVEMENT OF EXISTING METAL FENCE**  
 Location : REGIONAL REHABILITATION CENTER FOR YOUTH, AYALA, MAGALANG, PAMPANGA  
 Item No./Description : 804(1)a Embankment from Structure Excavation  
 Unit of Measurement : cu.m.  
 Output per hour : 9.840

	Designation	No. of Person	No. of Hours	Hourly Rate	Amount
A.	Labor				
	a. Construction Foreman	1	1		-
	b. Unskilled Labor	3	1		-
	Sub-Total for A				-
	Name and Capacity	No. of Units	No. of Hours	Hourly Rate	Amount
B.	Equipment				
	a. Plate Compactor (5 hp)	1	0.75		-
	b. Backhoe (0.80 cu.m.)	1	0.75		-
	Minor Tools (10% of Labor Cost)				-
	Sub-Total for B				-
C.	Total (A + B)				-
D.	Output per hour = 9.84 cu.m.				
E.	Direct Unit Cost (C ÷ D)				
	Name and Specification	Unit	Quantity	Unit Cost	Amount
F.	Materials				
	Sub-Total for F				-
G.	Direct Unit Cost ( E + F )				
H.	Overhead, Contingencies and Miscellaneous (OCM)			0.15 of G	-
I.	Contractor's Profit (CP)			0.10 of G	-
J.	Value Added Tax (VAT)			0.05 of (G + H + I)	-
K.	Total Unit Cost			(G + H + I + J)	-

Prepared by:

Submitted by:

**ROMMEL G. VELASCO**  
 Engineer II

**ROBERT V. GATMAITAN**  
 Center Head



### DETAILED UNIT PRICE ANALYSIS (DUPA)

Project : **REPAIR AND IMPROVEMENT OF EXISTING METAL FENCE**  
 Location : REGIONAL REHABILITATION CENTER FOR YOUTH, AYALA, MAGALANG, PAMPANGA  
 Item No./Description : 803(1)a Structure Excavation (Common Soil)  
 Unit of Measurement : cu.m.  
 Output per hour : 20

	Designation	No. of Person	No. of Hours	Hourly Rate	Amount
A.	Labor				
	a. Construction Foreman	1	1		-
	b. Unskilled Labor	3	1		-
	Sub-Total for A				-
	Name and Capacity	No. of Units	No. of Hours	Hourly Rate	Amount
B.	Equipment				
	a. Backhoe (.8 cu.m.)	1	1		-
	b. Dump Truck (12 cu.yd)	2	1		-
	c. Minor Tools (10% of Labor Cost)				-
	Sub-Total for B				-
C.	Total (A + B)				-
D.	Output per hour = 20 cu.m.				
E.	Direct Unit Cost (C ÷ D)				-
	Name and Specification	Unit	Quantity	Unit Cost	Amount
F.	Materials				
	Sub-Total for F				-
G.	Direct Unit Cost ( E + F )				-
H.	Overhead, Contingencies and Miscellaneous (OCM)			0.15 of G	-
I.	Contractor's Profit (CP)			0.1 of G	-
J.	Value Added Tax (VAT)			0.05 of (G + H + I)	-
K.	Total Unit Cost			(G + H + I + J)	-

Prepared by:

Reviewed by:

**ROMMEL G. VELASCO**  
 Engineer II

**ROBERT V. GATMAITAN**  
 Center Head

## DETAILED UNIT PRICE ANALYSIS (DUPA)

Project : **REPAIR AND IMPROVEMENT OF EXISTING METAL FI**  
 Location : REGIONAL REHABILITATION CENTER FOR YOUTH, AYALA, MAG  
 Item No./Description : Demolition  
 Unit of Measurement : l.s.  
 Output per hour : 1

A.	Designation	No. of Person	No. of Hours
	Labor		
	Dismantling of existing wiremesh and roof and tiles		
	a. Construction Foreman	1	8.00
	b. Skilled Labor	1	8.00
	c. Unskilled Labor	2	8.00
	Sub-Total for A		
B.	Name and Capacity	No. of Units	No. of Hours
	Equipment Cutting Outfit	1	8.00
	Sub-Total for B		
C.	Total (A + B)		
D.	Output per hour =		
E.	Direct Unit Cost		
F.	Name and Specification	Unit	Quantity
	Materials		
	Sub-Total for F		

G.	Direct Unit Cost ( E + F )	
H.	Overhead, Contingencies and Miscellaneous (OCM)	0.15
I.	Contractor's Profit (CP)	0.1
J.	Value Added Tax (VAT)	0.05
K	Total Unit Cost	

Prepared by:

Checked/Reviewed by:

Si

**JEMIMAH B. RAVAGO**

PDO II

**MARIO R. BAUTISTA/RICHARD R. GUTIERREZ**

Engineer III

**ENCE**

MALANG, PAMPANGA

Hourly Rate	Amount
	0.00
	0.00
	0.00
	<b>0.00</b>
Hourly Rate	Amount
47.72	381.76
	381.76
	381.76
	381.76
Unit Cost	Amount
	0.00

	381.76
of G	57.26
of G	38.18
of (G + H + I)	23.86
(G + H + I + J)	<b>501.06</b>

ubmitted by:

**JACQUELINE C. BAUTISTA**  
Center Head



## BILL OF QUANTITIES

Name of Project:	<b>REPAIR AND IMPROVEMENT OF EXISTING METAL FENCE</b>	Location:	<b>REGIONAL REHABILITATION CENTER FOR YOUTH, AYALA, MAGALANG, PAMPANGA</b>
Total Project Cost:	<b>PHP -</b>	Project Duration:	<b>60 Calendar days</b>
Source of Fund:	<b>TRUST FUND</b>	Mode of Procurement:	<b>Small Value Procurement</b>
Date:	<b>September 14, 2023</b>	Source of Manpower:	<b>Outsource</b>

I	CONSTRUCTION WORKS							
Item No.	Item Description		Quantity	Unit	Material Cost	Labor /Equipment Cost	Unit Cost	Amount
1	Site Preparation							
	1.1	Demolition	1.00	l.s			-	-
SUB - TOTAL (Site Preparation)								-
2	Civil and Earthworks							
	2.2	Structural Excavation ( Common Soil)	0.86	m <sup>3</sup>			-	-
	2.3	Embankment from Structure Excavation	0.38	m <sup>3</sup>			-	-
	2.4	Gravel Fill	0.14	m <sup>3</sup>			-	-
SUB - TOTAL (Civil and Earthworks)								-
3	Reinforced Concrete							
	3.1	Structural Concrete for Footing Tie Beam, Column, (Class A, 28 days)	0.60	m <sup>3</sup>			-	-
	3.3	Fabrication/erection and setting-up of Reinforcing bars	53.58	kg.			-	-
	3.4	Form,False works,braces,ribs	0.96	sq.m.			-	-
SUB - TOTAL (Reinforced Concrete)								-
4	Structural Steel Works							
	4.1	4" Sch.40 G.I. Pipe	1.00	l.s			-	-
	4.2	1 1/2 " Sch. 40 G.I. Pipe	1.00	l.s			-	-
	4.3	20 mm x 3 mm thk Flat Bar	1.00	l.s			-	-
	4.4	Steel Matting 2" x 2" x 2 mm GI	1.00	l.s			-	-
	4.5	Base Plate (150 mm x 150 mm x 8 mm thk)	1.00	l.s			-	-
	4.6	Anchor Bolts (12 mm dia.) w/ Nuts and Washers	16.00	pc			-	-
SUB - TOTAL (Structural Steel Works)								-

A	Total Direct Cost (Material, Labor and Equipment ) of Construction Works	-
B	Overhead, Contingencies and Miscellaneous (OCM) ( 15% of A )	-
C	Contractor's Profit (CP) ( 10% of A )	-
D	Value Added Tax ( VAT ) ( 5% of A+B+C )	-
<b>TOTAL PROJECT COST</b>		<b>P</b> -

Prepared by:

**ROMMEL G. VELASCO**

ENGINEER II

Submitted by:

Certified as to Funding Compliance with Budget Parameters and  
Inclusion in the **WFP**:

**ROBERT V. GATMAITAN**

CENTERHEAD

**RENANN M. MACAPINLAC**

AO V / BUDGET SECTION CHIEF

Recommending Approval:

Approved / Disapproved:

**MARIBEL M. BLANCO**

ASSISTANT REGIONAL DIRECTOR FOR ADMINISTRATION

**JONATHAN V. DIRAIN**

REGIONAL DIRECTOR, DSWD FO III

DSWD Field Office III, Diosdado Macapagal Government Center, Maimpis, City of San Fernando Pampanga, Philippines 2000  
Tel: (045) 861 – 2413 ; Telefax: (045) 961 – 2413  
Email: fo3@dswd.gov.ph  
Website: http://www.dswd.gov.ph



**PROGRAM OF WORKS**

Name of Project:	<b>REPAIR AND IMPROVEMENT OF EXISTING METAL FENCE</b>	Location:	<b>REGIONAL REHABILITATION CENTER FOR YOUTH, AYALA, MAGALANG, PAMPANGA</b>
Total Project Cost:	<b>PHP -</b>	Project Duration:	<b>60 Working days</b>
Source of Fund:	<b>TRUST FUND</b>	Mode of Procurement:	<b>Small Value Procurement</b>
Date:	<b>September 14, 2023</b>	Source of Manpower:	<b>Outsource</b>

<b>I CONSTRUCTION WORKS</b>					
Item No.	Item Description	Quantity	Unit	Unit Cost	Amount
<b>1</b>	<b>Site Preparation</b>	1.00	lot		-
<b>2</b>	<b>Civil and Earthworks</b>	1.00	lot		-
<b>3</b>	<b>Reinforced Concrete</b>	1.00	lot		-
<b>4</b>	<b>Structural Steel Works</b>	1.00	lot		-
<b>SUB TOTAL (Construction Works)</b>					<b>-</b>

A	Total Direct Cost (Material, Labor and Equipment ) of Construction Works	-
B	Overhead, Contingencies and Miscellaneous (OCM) ( 15% of A )	-
C	Contractor's Profit (CP) ( 10% of A )	-
D	Value Added Tax ( VAT ) ( 5% of A+B+C )	-
<b>TOTAL PROJECT COST</b>		<b>PHP -</b>

Prepared by:

**ROMMEL G. VELASCO**  
ENGINEER II

Submitted by:

**ROBERT V. GATMAITAN**  
CENTERHEAD

Recommending Approval:

**MARIBEL M. BLANCO**  
ASSISTANT REGIONAL DIRECTOR FOR ADMINISTRATION

Certified as to Funding Compliance with  
Budget Parameters and Inclusion in the

**RENANN M. MACAPINLAC**  
AO V / BUDGET SECTION CHIEF

Approved / Disapproved:

**JONATHAN V. DIRAIN**  
REGIONAL DIRECTOR, DSWD FO III